



CONVEYOR SYSTEMS DOOR

SAFETY FOR MAN
AND MACHINE

**ITW**
INDUSTRIETORE

**TORMAFA**
Maschinenschutz- und Industrietore



ADVANTAGES AT A GLANCE



Opening speed up to 2.0 m/s



Door size up to 5,000 mm x 5,000 mm



Horizontal or vertical opening



Low lintel requirement



Large selection of colours



Cut-outs possible



Personnel restraint system



Black main switch and emergency stop
(optional)

SPECIAL FEATURES

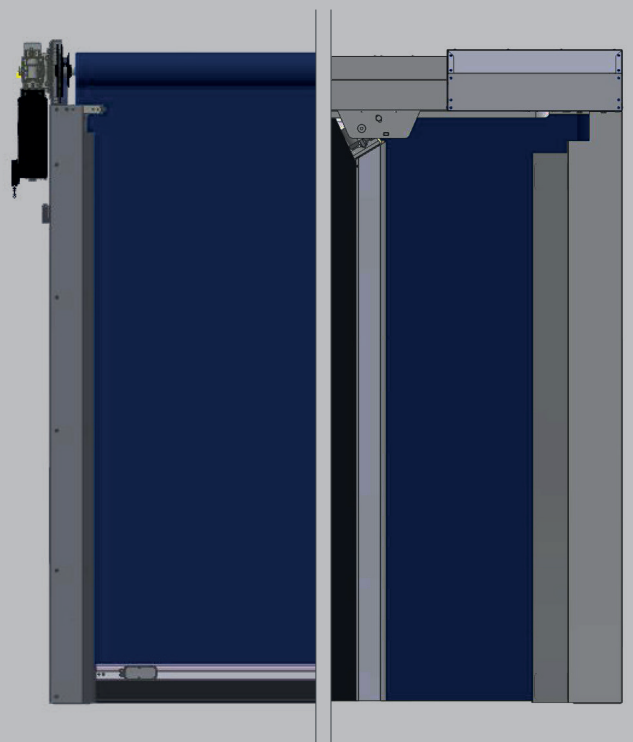

RELIABLE, FAST & SECURE

The machine safety gate specially developed for this application protects both man and machine without hindering the production process.

Fast production steps are possible thanks to the short cycle times. Our high-speed doors are used between production sections and storage areas within the conveyor system. There they serve as a demarcation of the plant areas, as personal protection and as fall protection in front of the lifting shaft.

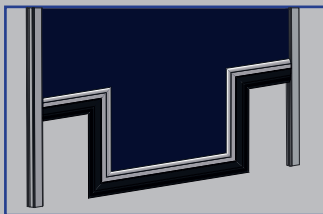

Vertical door with outside cut-out

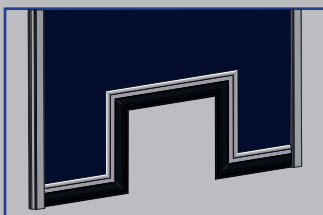

Vertical door with cut-out inside

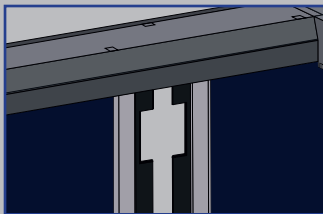

Horizontal door with cut-out in the rubber profile

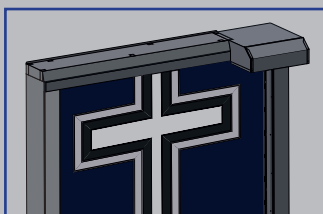

Horizontal door with large cut-out

TECHNICAL DATA

- Opening speed up to 2.0 m/s
- Closing speed up to 0.8 m/s
- Resistance to wind load up to class 1
- Door sizes up to 5,000 mm x 5,000 mm
- DR2100 microprocessor control unit with main switch and integrated frequency inverter
- 230 V/50Hz, IP54 operator
- Required lintel height min. 345 mm
- Curtain available in various colours
- Signal lights and traffic light control (optional)

SAFETY

- Drive-through monitoring by means of contactless light grid
- Emergency opening by hand crank or reel chain
- Safety switch for monitoring door closed

OUR FURTHER PRODUCT RANGE



SPIRAL DOOR



FOLDING GATE



HORIZONTAL HIGH-SPEED DOOR



VERTIKAL HIGH-SPEED DOOR



SWING DOORS



STRIP CURTAINS



MACHINE PROTECTION DOOR



SECTIONAL DOORS



STEEL / ALUMINUM ROLLER DOORS

SCOPE OF APPLICATION



INDUSTRY



TRANSPORT



LOGISTICS



AUTOMOTIVE



M. PROTECTIONS



CLEAN ROOM



SUPERMARKET



FOOD



COOLING AREA



ATEX

ITW Industrietore GmbH
Adolf-Kolping-Straße 14
73072 Donzdorf
Germany

Tel. +49 7162 9129-60
Fax +49 7162 9129-64
info@itw-torsysteme.de
www.itw-torsysteme.de

**ITW**
INDUSTRIETORE